

Accessibility Guide for Brighton Caravan & Motorhome Club Site

Contact for Accessibility Enquiries: Please ask for the Duty Manager

✉ brighton@camc.com

☎ 01273 626546

🌐 [https://www.caravanclub.co.uk/club-sites/england/south-east-england/east-sussex/
brighton-caravan-club-site/](https://www.caravanclub.co.uk/club-sites/england/south-east-england/east-sussex/brighton-caravan-club-site/)

At a Glance

Level Access

- A lot of the site is set relatively level but some areas are subject to steep gradients (in excess of 1:12)
- All facilities, except the Camping Pods, Glamping Pods and Airstream Caravans, have level access in at least one location

Step only Access

- Camping Pods
- Glamping Pods
- Airstream Caravans

Accessible Toilets and Showers

- There are 2 accessible combined toilet and shower cubicles, one in Toilet Block A and one in Toilet Block B

Accessible Pitches

- No designated accessible pitches, however pitches are allocated according to your needs or preference, so please contact us in advance to discuss your requirements.



We support the Hidden Disabilities Scheme

- Our organisation supports the Hidden Disabilities Scheme, lanyards and pins are available in reception.

Site Address

East Brighton Park
Wilson Ave
Brighton
BN2 5TS

Arrival and Reception

Approach Route

- The reception building is immediately on your left as you enter the site.
- Access into the site is through a vehicle barrier controlled by card access. The card reader is set 1200mm above ground level; this is accessible from most cars and motorhomes.
- The ground is level in this area with hard surfaced paths linking facilities.

Parking

- Parking for new arrivals is set within a few metres of the Reception building.
- 1 late arrival bay of sufficient size for a car and caravan is set opposite reception with access to an electric charging point. This area is used for visitor parking until 8.00pm, but is by request only.

Entrance into Reception

- The entrance is accessed via a ramp of around 6 metres in length.
- The ramp has a handrail.
- The entrance door has a width of 870mm over a level threshold
- The entrance door is “Push to Open”
- The entrance door is not power assisted
- A call point is available if you need assistance

Reception

- There is a decent amount of space in front of the desk. This space is around 1100 x 1500mm
- The desk incorporates a low level position set 715mm above floor level with 770mm clear knee space beneath
- The desk is not fitted with a hearing loop



Getting around the Site

- The site slopes gently upwards from the entrance to the North of the site
- There are a limited number of dedicated footpaths so pedestrians generally share vehicles routes, which have well maintained tarmac, however do incorporate some speed-bumps
- Pitches 76 – 104 are located on a higher part of the site (gradients on the approach exceed 1:20.) The footpath linking these pitches to toilet block B is steeper (more than 1:12)
- The Eastern tent fields are accessed from a pedestrian tarmac footpath and access road to gravelled parking areas (gradients exceed 1:12).
- Access to the Glamping pods is via site roads and paths that are much steeper (up to 1:6)

Touring Pitches

- There are 151 pitches in total, 133 of which are on hard standing.
- There are 23 fully serviced pitches with dedicated drainage and water supplies.
- Roll out mats are not provided
- There are no designated accessible pitches, however pitches are allocated according to your needs or preference, so please contact us in advance to discuss your requirements.
- There are 8 hard standing pitches within 40m of toilet block A
- There are 14 hard standing pitches within 40m of toilet block B on a level section of the site.
- Pitches are allocated according to need/preference. Please contact us in advance to discuss your requirements.
- If a specific pitch is required we can reserve it for you, and this will be done with discretion.
- TV BOOSTER SYSTEM ON SITE



This is an example of a “Pitch in Use” sign we can use to reserve a pitch for you.

Camping Pitches

- There are 25 pitches in total, all on grass, on two separate tiered fields towards the rear of the site.
- The lower tier has 16 pitches, 8 with electrical hook-up. There is level parking at one end of the camping field for 12 cars, and the toilet block is available at the opposite end of the field. There are no accessible toilet or shower facilities in this block.
- The upper tier has 9 pitches. There is level parking at one end of this camping field for 12 cars. At the opposite end of the field is a covered barbecuing platform for disposable barbecues, set at a height of 880mm.
- A service point with water and drainage is adjacent to the barbecue area.
- A hard-surfaced steep sloped footpath (gradient up to 1:6) leads from both tiered fields down to the main part of the site.

Toilets and Changing Facilities

Accessible Toilets and Bathing facilities – Reception

- There is a combined Accessible Toilet and Shower cubicle, which is located, opposite the Reception building.
- The cubicle door is approximately 830mm, over a 20mm deep threshold
- The cubicle door is secured by RADAR key. You can borrow a key from Reception.
- The cubicle's dimensions are 3480mm x 2800mm
- The WC pan is left hand transfer
- The shower seat is right hand transfer
- The cubicle is fitted with a pull cord alarm; this is tested on a weekly basis to ensure it works.
- A vanity worktop set 730mm above floor level is provided with 200mm clear kneespace
- The shower seat and WC Pan are fitted with grab rails to assist transfer
- Basin taps and shower controls are fitted with levers



Accessible Toilets and Bathing facilities – Toilet Block B

- There is a combined accessible toilet and shower cubicle in Block B. This is accessed by a ramp set with a single handrail.
- The cubicle door is approximately 820mm wide, over a 30mm deep chamfered (sloped) threshold.
- The cubicle door is secured by RADAR key. A key can be loaned from Reception
- The cubicle's dimensions are 2300 x 2050mm.
- The WC pan is right hand transfer.
- The shower seat is left hand transfer.
- The cubicle is fitted with a pull cord alarm; this is tested on a weekly basis to ensure it works.
- The shower seat and WC Pan are fitted with grab rails to assist transfer.
- Basin taps and shower controls are fitted with levers.



Standard Toilets and Washrooms

- There are 3 toilet and shower blocks on site; adjacent reception (A), set centrally (B) and to the east serving the tent fields (C).
- Toilet blocks A and B have a firm, level approach. Toilet block C is approached by steps or a steep path.
- Block A has a stepped threshold of 150mm. Blocks B and C have a chamfered (sloped) threshold of 30mm.
- Entrance doors to Blocks A and C are 740mm wide, and to Block B 710mm wide.
- Combined shower and WC cubicles are available in Blocks A and B only. These are fitted with grab rails.
- Shower cubicles generally achieve level access with a flush gully.
- Basins, WCs and showers are generally fitted with lever controls although some WCs and showers are fitted with push button controls.

Other facilities

Laundry – Toilet Block A

- There is a ramped approach with a single handrail.
- The door is 840mm wide, over a 20mm threshold.
- Washing machine is positioned on the ground to allow for easy access.
- Tumble dryer is placed above the washing machine.
- Sinks set at 900mm high with 780mm knee space below
- Sinks fitted with knob taps



The tumble dryer is on top of the washing machine.

Laundry – Toilet Block B

- There is a ramped approach with a single handrail.
- The door is 730mm wide, over 20mm chamfered (sloped) threshold.
- Circulation space within narrows to 670mm.
- Limited manoeuvring space
- Washing machine and tumble dryer are both positioned on the ground to allow for easy access.
- Sinks set at 900mm high with 760mm knee space below.
- Lever taps fitted



The washing machine and tumble dryer are on the same level.

Dishwashing – Toilet block A

- Door clear width 800mm over level threshold
- 910mm high worksurface with sinks. No kneespace.
- Lever taps

Dishwashing – Toilet block B

- The door is 820mm wide, over 20mm threshold
- 890mm high worksurface with sinks. No kneespace.
- Lever taps

Dishwashing – Toilet block C

- Open fronted under canopy
- 950mm high worksurface with sinks. No kneespace.
- Lever taps

Baby and Toddler Washroom – Toilet Block A

- Located within the information room block, close to reception
- Door is 800mm wide, over level threshold
- Digital lock access set 1350mm above floor level
- A half sized bathtub, a lower and smaller WC, and a lower and smaller basin.
- Wall mounted baby change unit set 900mm above floor level
- Lever style taps

Baby and Toddler Washroom – Toilet Block B

- Door is 740mm wide, over a level threshold
- Digital lock access set 1400mm above floor level
- 2300 x 2400mm. Limited manoeuvring space.
- A half sized bathtub, a lower and smaller WC, and a lower and smaller basin.
- Wall mounted baby change unit set 900mm above floor level
- Lever style taps

Information Room – Opposite Reception

- There is a graded approach set between 1:15-1:20. No level landing to entrance door.
- The door is 780mm wide, over a level threshold
- There is a defibrillator mounted on the wall outside of the information room for emergency use.

Service Points

- Located at regular intervals around site – check the site map for details
- Level access from roads
- Narrow access to some service points, as narrow as 600mm in some places
- There is a CamperClean unit next to Toilet Block A



CamperClean unit, next to Toilet Block A.



Chemical Waste Service Point - these can be found at various intervals across the site.

Children's Playground

- Located centrally next to Toilet Block B
- Level access
- Gate is 980mm wide and opens inwards, the other entrance does not have a gate
- Range of play equipment mounted on safety surfacing



Dog Pit Stop

- Located centrally next to Toilet Block B
- Level access from roads
- Gate is 1100mm wide
- Hardstanding at entrance. Exercise area is grassed.

Onsite Accommodation

There is a range of onsite accommodation available to book to stay in. The details of each accommodation are below.

Glamping Pods

- There are 10 glamping pods situated on the hillside to the east of the site.
- These are accessed by steep site roads and paths (up to 1:6 gradient).
- There is a gravel car park with one designated accessible bay.
- Stepped approach from car park to pods. There are handrails on both sides. There are 16 steps up to the pods.
- The bin store is at the bottom of the steps, next to the cycle parking bay.
- Hard surface path leading from gravel parking to each pod.
- Steps up to each pod with handrails to both sides.
- Entrance doors are 830mm wide over a 70mm threshold.
- Corridors within can be as narrow as 430mm.
- The bathroom has very narrow walkways - it can only accommodate one adult at any time.
- Lever taps in bathroom and kitchen



Stepped access up to Glamping Pod only.



The corridor to the kitchen and bathroom is very narrow as can be seen in the left of the photos.



With all of the beds pulled out there is limited moving space.



The main double bed is a “Pull Down” with the handle for this at 2meters high. The bed requires a reasonable amount of effort to pull out.

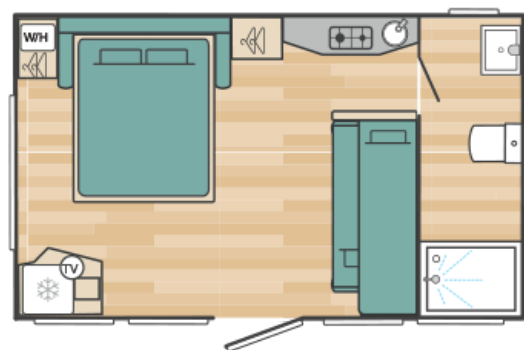
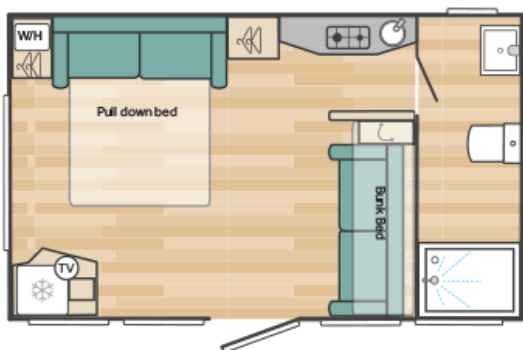

Floorplan of the Glamping Pod in both daytime and nighttime layouts.



The bathroom inside the Glamping pods is very narrow.



The approach to the Glamping Pods is either from the “Glamping Car Park” - where they are accessed via a staircase, or from a steep footpath from the tent fields.

There is a trolley available at the top of the steps to help take luggage to each pod



Layout of the Glamping Pods and car park



The path linking all of the Glamping pods has a hard surface.

Camping Pods

- There are 2 camping pods situated close to reception.
- These are set on level part of the site.
- There are 3 steps up to each pod with handrails to both sides.
- Overall dimensions are 3400 x 2200mm.
- Contains 2 camp beds, 2 chairs and a table.



There is stepped access into the camping pods only



There is some moveable furniture which can allow for extra room for movement.

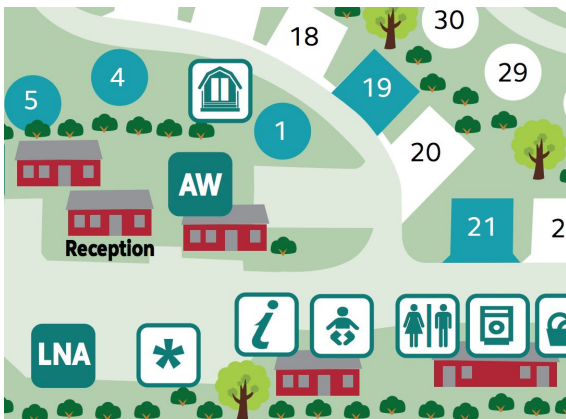

The Camping Pods are within 50m of Reception and 75m of Toilet Block A.

Information

Written Information

- A Large print version of the site leaflet is available from Reception.
- A range of leaflets for local attractions are available in the Information Room. A magnifying glass is available from Reception upon request.
- Please ask at reception if you have difficulty reading third party leaflets and staff will be happy to read these to you upon request.

Customer Care & Support

Booking Procedures

- If you have any specific requirements for your stay please contact the site directly and they will be happy to discuss your requirements and reserve you the most suitable pitch wherever possible.
- We are happy to reserve pitches for you discreetly, with a “Pitch in Use” sign.

Evacuation

- There are assigned assembly points should an evacuation need to occur, and you will be directed to your nearest one in the unlikely event this should happen.

Customer Care and Staff Training

- All on site staff have received disability awareness and etiquette training.

Public Transport

- Local bus stops are situated on Wilson Avenue to the west of the site.
- The nearest stop serves the Stanley Deacon Leisure Centre. This is around 200 metres from the site entrance and is accessed over East Brighton Park. The direct route involves travel over informal grassed areas. There is no formal path linking the site to these stops via a direct route.
- The stops serve routes 21 and 21A with regular services to Brighton and Hove.
- Further details can be found on the bus operator websites

<https://www.buses.co.uk/>

Taxi

Please contact the site staff, who keep a list of local taxi companies including those offering a wheelchair accessible service where available.